



2015

Celli solutions for



Summary

Celli, since 40 years
world leader in design and technology pag. 4

The winning path takes an
ecological route pag. 6

Celli multivalve technology pag. 7

Telemetry technology pag. 8

Our solutions for Pepsi pag. 10

Towers

Galaxy pag. 12

Polar pag. 16

Polar max pag. 17

Polar with clamp pag. 17

Tristar pag. 18

Tristar max pag. 19

Flexa-star post-mix pag. 20

Flexa-star pre-mix pag. 21

Flexa-star pre-mix with clamp pag. 21

Cool 6 pag. 22

Cool 3 high with clamp pag. 23

Cool 3 low with clamp pag. 23

Adria pag. 24

Classic pag. 24

Barocco pag. 24

Overcounters

Joy range pag. 25

Joy 20 pag. 29

Joy 30 pag. 30

Joy 50 pag. 31

Joy 65 pag. 32

Smart pag. 33

Polo 30 pag. 36

Polo 50 pag. 37

Overcounter range pag. 38

Undercounters

Brave range pag. 39

Brave 120 pag. 41

Brave 90 pag. 42

Brave 60 pag. 43

Brave 30 pag. 44

Eclipse range pag. 45

Eclipse horizontal pag. 46

Eclipse vertical pag. 47

Eclipse 50 pag. 48

Cube pag. 49

Undercounter range pag. 51

Drop-in

Drop-in + Freestanding + Cool pag. 52

Drop-in + Cool pag. 52

Drop-in + Tristar pag. 53

Drop-in Integrated towers pag. 54

Drop-in pump box pag. 54

Bar-guns

Wunder-bar gun pag. 55

Bar-gun holders pag. 56

Accessories pag. 57

Our Certifications pag. 59

Celli
solutions for



pepsi®

Pouring a drink is an art.

Freshness, quality and flavours are essential characteristics that make each beverage a unique experience to be savoured.

For 40 years, Celli S.p.A. has preserved this art through continuous innovation and originality, offering quality products with a refined design for the best drinking experience.

Celli is your partner in co-engineering innovative projects and strengthening your brand.

since 40 years **world leader** in design and technology

With 40 years of experience Celli S.p.A. has become the number one Italian company in the drink dispensing system, and one of the main reference points at a global level. The Celli S.p.A. drink dispensing products are nowadays exported worldwide. The systems for the refrigeration of beverages, towers, taps and other accessories for the dispensing of drinks are designed and manufactured in Rimini - Italy in a factory covering 10,000 square meters. The success of this industrial reality is due to the company's philosophy aimed at:



Design to create new trends and icons

Innovation, originality of the products, the elegant and exclusive design, the noticeable Italian character, the continuing pursuit of quality both through increasing investment in advanced technologies as well as trained and highly motivated staff: these factors have

permitted Celli S.p.A. to remain in tune with national and international market needs, often anticipating demand by proposing cutting edge products for their technical solutions and design.



Technology to pursue continuous innovation

We adopted different solutions in order to maximize our process efficiency. A modern production line to maintain high levels of flexibility and control and at the same time to ensure maximum ergonomics to the operator. A tracking system of the main cooler components, thus allowing to trace the production batches of components through the machine's serial number, with this method it is possible to act in a timely and focused manner

on products already on the market, intercepting and correcting any deficiencies. The system's production line test procedures have also been automated so as to reduce the chances of human error to a minimum. A warehouse facility with two sections: an automated area for handling around 14000 cases and a storing area for 6000 items with two cable-driven forklifts.



Quality for an amazing drinking experience

Celli showed that the quality of its offer is not only associated to the finished product but also to the productive process, to good services and technical assistance following the product on the market. Quality is not just associated to the finished product. Quality is part of a complete process that includes a good service and technical assistance. We guarantee to our customer a reliable assistance service that can be implemented in an efficient and continuous manner.

The internal policy of Celli S.p.A. concerning quality has always been strict and rigorous, pushing towards an initial IMQ certification on their systems in the early eighties. The course towards a steady expansion of its certification has continued over the years, reaching important results: the achievement of the UNI EN ISO 9001: 1994 certification on July 1994 and UNI EN ISO 14001: 2000 on January 2002.



Eco-friendly solutions to reach environmental sustainability

At Celli respecting the environment has always been a priority that we take very seriously. One of the most important stages in Celli's history has been the introduction of the R134 gas replacing the noxious R12 gas. The first company in the sector to make this choice and introduce it on the market, Celli also has the merit of removing CFC from the polyurethane foam from the tanks of the coolers well before legal obligations were implemented, at a time when very few cared for the environment. The use of new expanding HFC-free foams, such as CO₂, has also been introduced to

avoid heat loss. Celli has strived for years to make the insulation of the cooler's tanks thick enough to avoid heat loss, using quality pythons of high thickness to prevent the dispersion of energy along the course of the chilled drinks from the system to the tower and using its standard low energy consumption electronic compressor and fan motor systems. Due to their maximum sensitivity in this area, Celli continues to work in this direction experimenting innovative solutions for environmental protection.



your partner in co-engineering innovative projects and strengthening brand

Distinguish oneself and maintain product quality at the highest level. This is the commitment of Celli S.p.A. to remain a privileged partner capable of meeting the future challenges. Our history of design and tradition make it possible to travel with you along open roads on the new challenges of the global market.

- R&D team: dedicated developers, designers and engineers.
- Three-dimensional solid modeling programs such as PRO-Engineering on powerful HP Graphic Workstations.
- The workstations with CAD software for graphic design and 3D design are linked directly with a rapid prototyping 3D printer that allows obtaining samples of many of the products still in the design phase.



- Our technical and prototyping office is able to simulate a preview of coolers and towers, allowing us to evaluate with great precision the technical capabilities and aesthetic impact in preproduction, thereby saving the timing related to design and implementation.
- The R&D laboratory, which has been certified by Pepsi, contributes to the optimization processes of both existing and new drink dispenser systems and accessories, thanks to testing and verification with modern analysis tools and computerized data acquisition and processing systems.
- There are currently 3 climatic chambers that can simulate any climatic and electrical condition allowing specific tests to be performed following the specifications of clients from all over the world.
- Particular attention is paid to finding new components in the electromechanical and thermodynamic field as well as innovative technological, environmental and energy saving solutions.
- Product quality control audit: working team dedicated to the control on both the incoming goods and on the finished product in order to ensure the perfect finishing and functionality of each item.

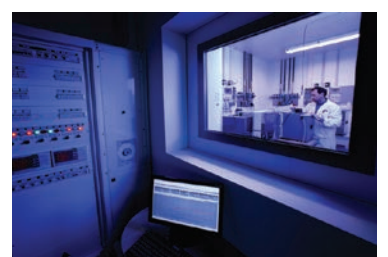

the winning path
takes an ecological route

Technological potential founded on sustainability

A new addition to the PEPSI-COLA range of post-mix coolers. In keeping with its environmental sustainability policies and market requests for increasingly ecological systems, Celli has been working for some time on the optimisation of the cooling circuits in its dispensers. One winning choice was the use of R290 (propane) refrigerant gas, which is fast becoming an important, ecological alternative to R134a gas for various applications. The entire range of PEPSI systems is therefore now available in both an R134a version and an R290 propane version - a gas for which Celli has a specific production line.

Today Celli has a vast range of coolers capable of functioning with different liquid refrigerants, respecting safety standards and providing excellent performances from both an environmental as well as energy viewpoint. The R290 coolers have been tested at the TÜV, through the verification and certification of compliance with all current safety standards.

With the introduction of this liquid refrigerants Celli met the target of minimising the greenhouse effect of the systems (R290 has a minimum GWP) and at the same time it considerably reduced electrical energy consumption (in some cases also by 40-50% compared to the corresponding R134a version, data certified by the independent third party Cermet), making Celli one of the top companies in the sector and a global leader for this type of technology.



Celli Multivalve Technology

Soft-drink dispensing is increasingly developing in view of generating a “consumer experience” capable to retain customers in time, and will therefore play a crucial role in the creation of this “drinking experience” in the next few years. The market launch of flavors to customize beverages makes the experience even richer.

Celli, always focused on market trends and developments, has conceived a product that combines innovation and experience.

The Celli multivalve technology allows to adjust the water and syrup flow through high-precision stainless steel controls, ensuring that perfect drinks are dispensed according to the highest standards set by beverage groups.

Compared to standard valves the multi-valve technology has a small footprint and allows to deal with many different products.

The multi-valve also allows the use of the presently most successful user interface –the touch display.

It is possible to easily switch from a carbonated drink to a non-carbonated drink without handling the hydraulic connections.

Celli multi-valve technology allows to dispense soft drinks also in combination with multiple flavors that help “customize” the drink and thus create a unique experience: a single tower allows to obtain up to 40 combinations!

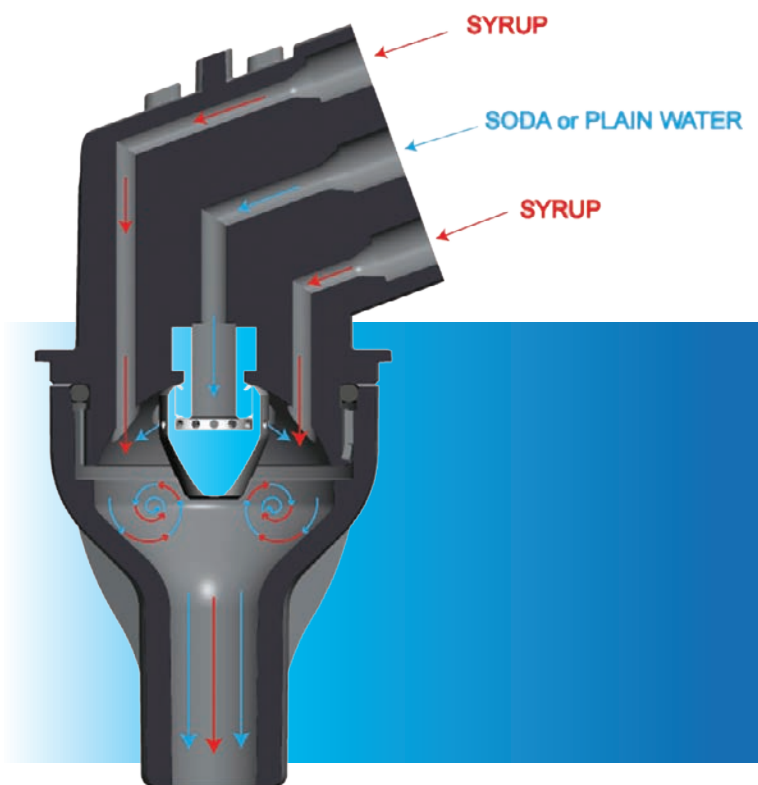

Telemetry Technology

For several years Celli has been aware of the need to adopt an advanced “intelligence” to fit into its equipment. The telemetry technology system provides major benefits, including remote monitoring of the amount of dispensed beverages and the appropriate operating status of the cooling circuit’s components, thereby ensuring that any malfunctions are detected in good time to prevent failures.

How does it work?

The telemetry system includes:

- A web-based user interface, which allows to access the telemetry system’s functions to connect remotely with the coolers from anywhere in the world.
- A telemetry device installed within the dispensing unit (cooler) and equipped with a SIM card to broadcast data to the server via the GPS network.

Benefits

This technology has unquestionable benefits, both from the technical and the strategic viewpoint.

Sales & Marketing

- The telemetry system displays consumptions for each Point of Sale (POS).
- It supports marketing decisions by providing real-time data about brand consumption.
- It is capable to monitor consumption trends thus allowing the premise to enhance cooler performance and only increase power when necessary.



A new opportunity to optimize the efficiency of your dispensers while increasing sales

Diagnostic

- The diagnostic system provides water bath and beverage temperature, power supply voltage, water pressure and time-out pump alerts, and other important alert signals.
- When these values approach the alarm thresholds, maintenance interventions can be scheduled to prevent malfunctions.
- Through diagnostic and alert systems, telemetry provides real-time information about the maintenance requirements of each POS.

Maintenance & Logistic Optimization

- Consumption analysis and the geo-localization system allow to optimize the supply chain by only providing Bag in Box whenever it is truly needed.
- The geo-localization system carries out constant monitoring of the cooler's position, thus preventing potential thefts.
- Monitoring of sanitation performance can be performed and beverage dispensing can be stopped if the lines are not perfectly clean.



Technology is ready to turn the abundant collected data into strategic assets!



Eclipse horizontal

OUR SOLUTIONS FOR PEPSI

High end equipment

TOWERS

Galaxy



Polar



Tristar



Flexa-star



OVERCOUNTERS

Joy range
20, 30, 50, 65



UNDERCOUNTERS

Brave range
30, 60, 90, 120



Entry level equipment

TOWERS

Cool



Adria



Barocco



Classic



OVERCOUNTERS

Smart



Polo
30, 50



UNDERCOUNTERS

Eclipse range
vert, hor, 50



Cube



Galaxy

a highly innovative
all-Celli project



*Eye-catching
tower*

*Touch screen for
friendly use interaction*

*Multiple flavor combination and juices with pulp
dispensing for an excellent drinking experience*

Galaxy is the ideal tower for big self-service chains. Innovation, efficiency, multiple flavors and easy maintenance make this tower the ideal answer to the highest standards of beverage groups.

It allows a wide choice among a wide range of soda or still soft drinks, also in combination with multiple flavors and with the possibility to dispense juices with pulp.

Up to 40 different combination in one tower for Pepsi dynamic customers!

Best Italian design



- Exquisite Italian design which allows to valorize any context.



- Compact overall dimensions and small footprint.



- Refined lines, modern look and feel.



- Laser cut stainless steel panels with illuminated embossed logo.



- Illuminated edges.



- Elegant details.

Engaging Software

User interface



Capacitive touch screen technology

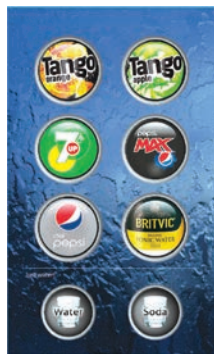

Drink brand selection

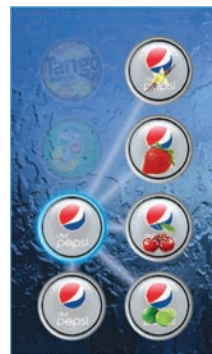

Flavor combination

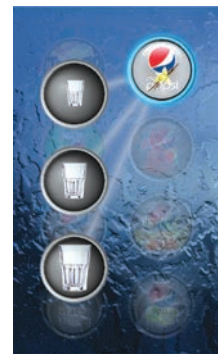

Cup size selection

Setting & Maintenance functions



Main menu



Language settings

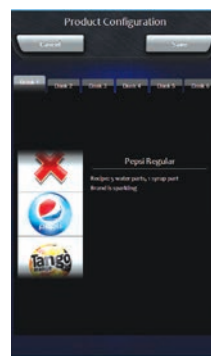

Brix setting



Dispensing selection: push mode or 3 programmable cup sizes



Semiautomatic sanitation procedure

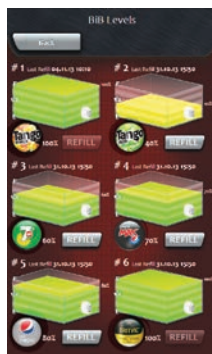

BIB level control and empty bib detection

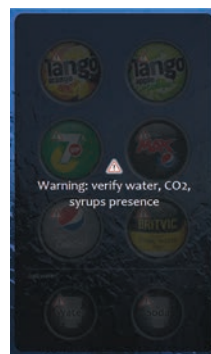

CO₂ and H₂O pressure detection



Sales statistics control

The software can be adapted upon specific requests.

Celli Multivalve Technology

- Mixing chamber
- Stainless steel flow control for consistent ratio stability
- Designed to dispense juices with pulp
- System to avoid cross contamination on syrups and flavors
- Developed in exclusive partnership with Parker Hannifin
- Patent pending

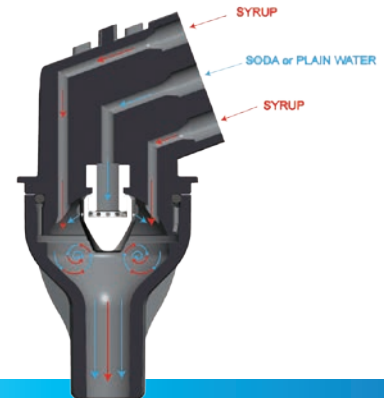

Wide choice among a wide range of soda or still soft drinks

12 soft drink syrups or 8 soft drink syrups
+
max 4 flavors 1 soda, 1 still water

Combination with multiple flavors

up to 40 different options in one tower

Electronic and Hydraulic box

Hydraulic and electronic parts in a very compact box

- Syrup solenoids with flow control
- Control box
- Transformer
- In/out ports
- Flavor flow regulators

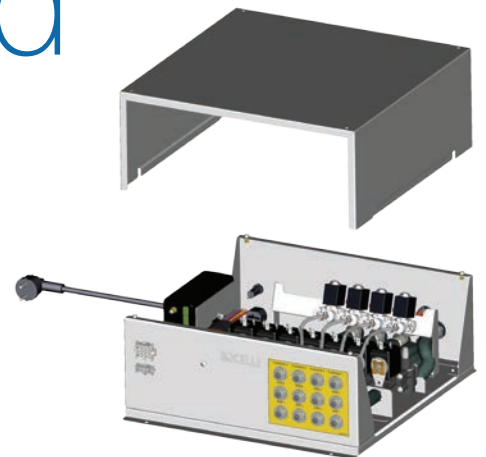

The electronic box can be accommodated under the counter closed to the tower

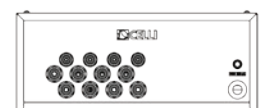
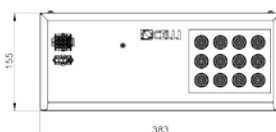
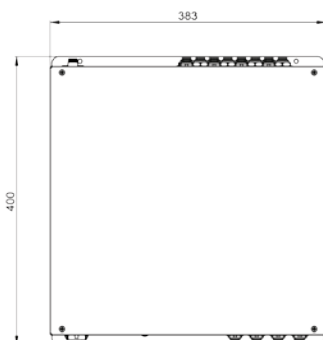

Polar



Body in ecofriendly vitreous material

Broad eye-catching display

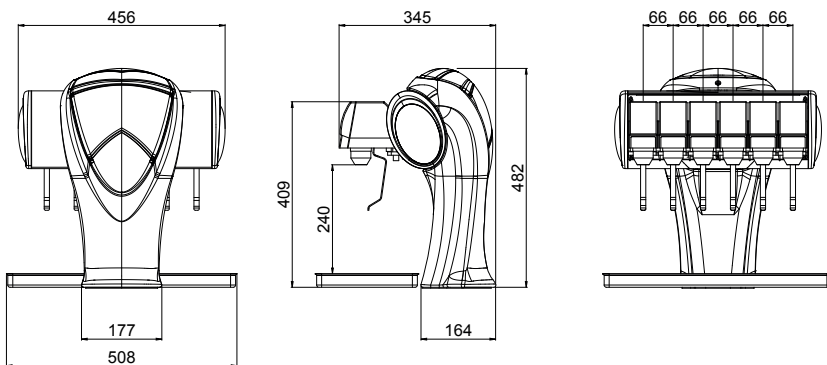

cod. 78937 Polar blue Pepsi
6 valves + water switch

**AVAILABLE WITH
3,4,6,8 VALVES**

Polar max

AVAILABLE IN
PEPSI MAX VERSION



Brand logo on all 4 sides

Polar with clamp

AVAILABLE IN
CLAMP FIX VERSION

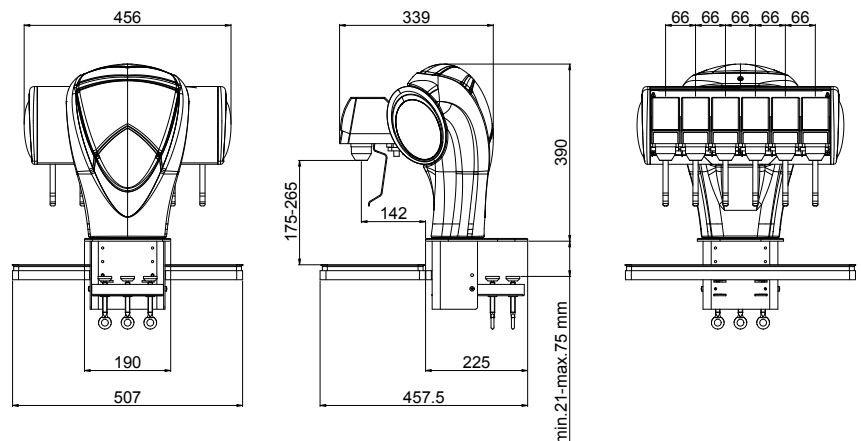

Tristar



**AVAILABLE WITH
4,6,8 VALVES**

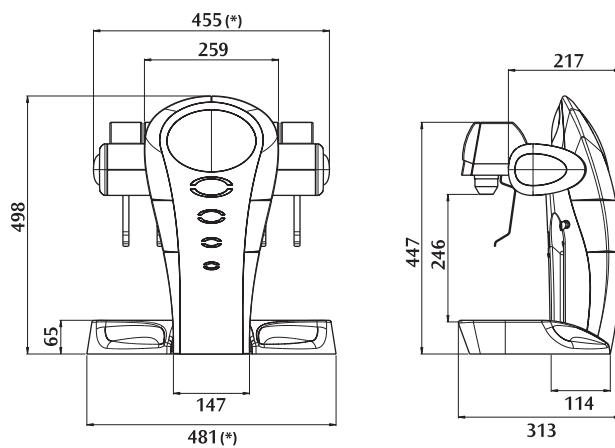

cod. 76885 Tristar Pepsi
6 valves + water switch

(*) 4 valves version: 325 mm
(Drip Tray 350 mm)

8 valves version: 587 mm
(Drip Tray 615 mm)

Tristar

max



**AVAILABLE WITH
4,6,8 VALVES**

cod. 69705 Tristar Pepsi Max
8 valves portion control + water switch

(*) 4 valves version: 325 mm
(Drip Tray 350 mm)

8 valves version: 587 mm
(Drip Tray 615 mm)

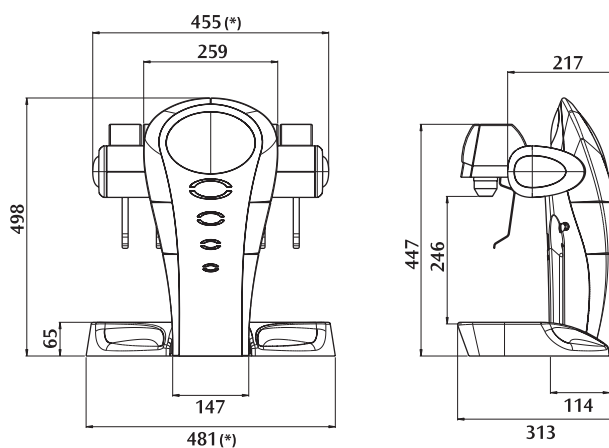

Flexa-star

post-mix



FLEXA STAR 2 VALVES + COUNTER FIX

cod. 80000 Flexa-star Pepsi
post-mix 2 valves

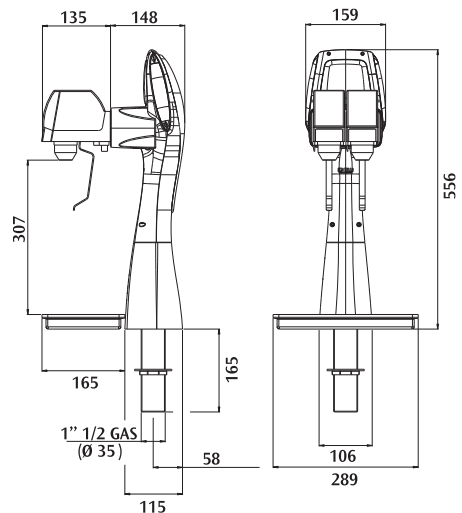

Flexa-star

pre-mix



**FLEXA STAR 3 TAPS
+ DRIP TRAY CLAMP FIX**

**FLEXA STAR 3 TAPS
+ DRIP TRAY COUNTER FIX**

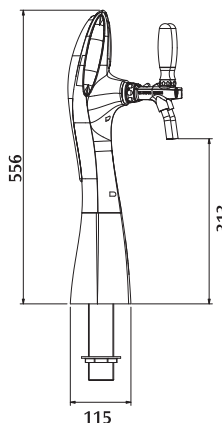
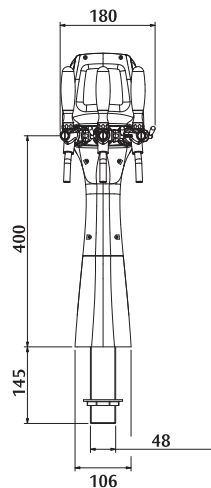
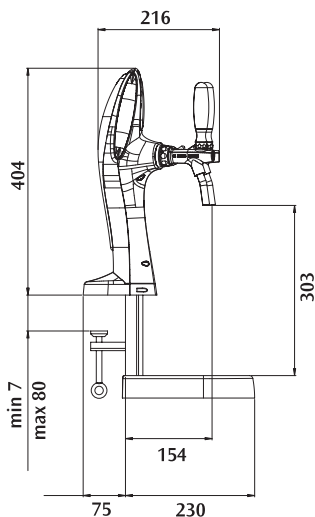
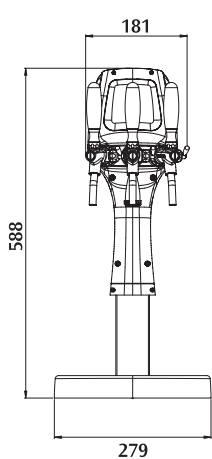

Cool 6



**AVAILABLE WITH
4,6,8 VALVES**

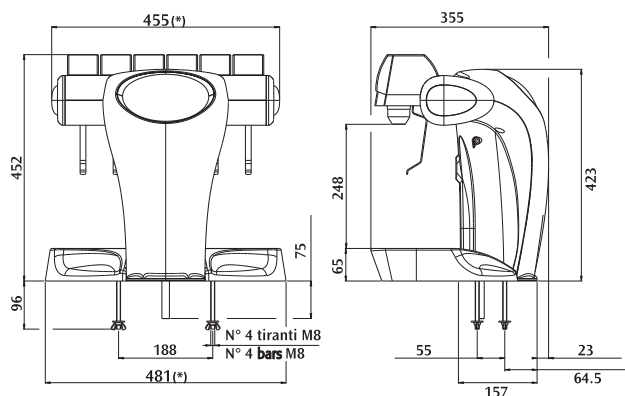

cod. 78128 Cool 6 Pepsi 6 valves + portion control
cod. 77459 Cool 6 Pepsi 8 valves + portion control

(*) 4 valves version: 325 mm
(Drip Tray 350 mm)

8 valves version: 587 mm
(Drip Tray 615 mm)

Cool 3 high with clamp



Cool 3 low with clamp

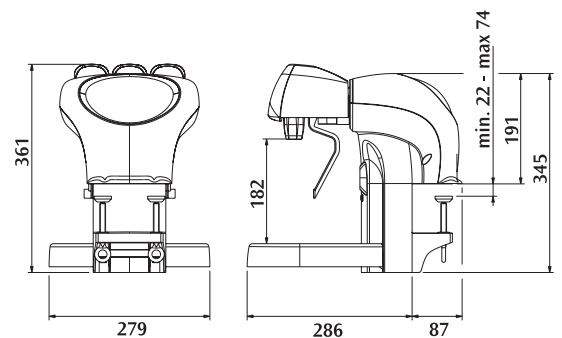
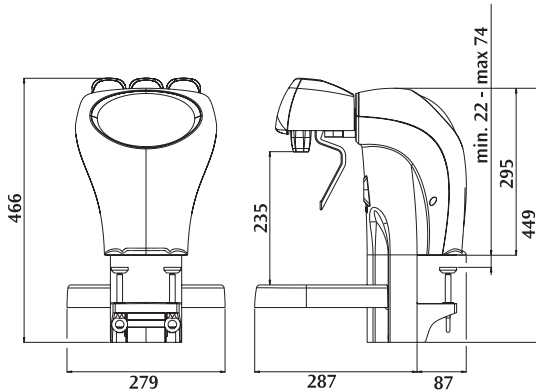

Adria

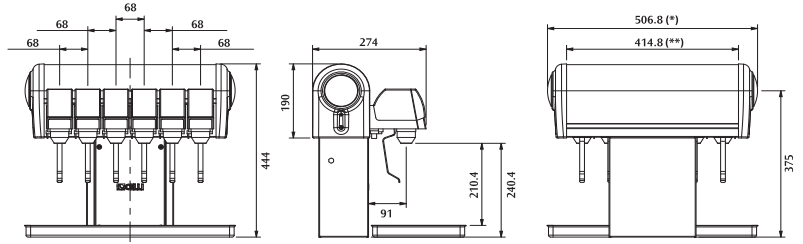

**AVAILABLE
PRE-MIX / POST-MIX**

**AVAILABLE WITH
4,6,8 VALVES**

(*) 4 valves version: 370.8 mm
8 valves version: 642.8 mm

(**) 4 valves version: 278.8 mm
8 valves version: 550.8 mm

Classic



Barocco

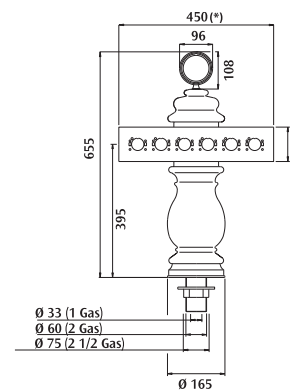

(*) INCLUDES
NON SHAPED DRIP TRAY

**AVAILABLE WITH
4,6,8 VALVES**

(*) 4 valves version: 310 mm
8 valves version: 600 mm

Joy

Best-in-class green overcounter



*Top-level technology
in an easy-to-use dispenser*

*Exclusive design
for maximum brand enhancement*

*A wide range of
configurations to meet any need*

The Joy range is the ideal answer to the maximum standards of beverage groups.

Celli developed an extremely innovative postmix overcounter, which meets the highest needs of major beverage groups. The Joy range was engineered with a top-level technology for an excellent performance and low energy consumption.

Joy is the most successful way to surf the ecological wave thanks to energy-saving solutions and the eco-friendly cooling gas.

With a comprehensive range of configurations, the Joy range ensures utmost flexibility without compromises in terms of best Italian design: exquisite lines and eye-catching areas for a unique, inimitable style.

Joy range

Best-in-class green overcounter



Environmental Sustainability

The Joy range is focused on environmental awareness. Energy-saving solutions based on eco-friendly cooling gases are the most successful way to surf the ecological wave.

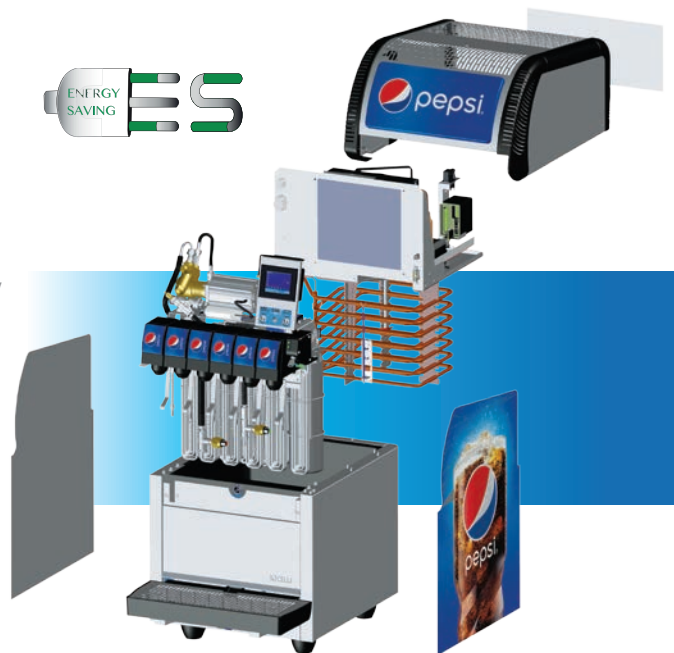

Easy Maintenance & High Performance

The Joy range was engineered for smart maintenance and easy installation. Key components are “Made in Italy”, ensuring high performance and the quality and reliability of our countertop units. The still water kit ensures consistent quality of the dispensed drinks.

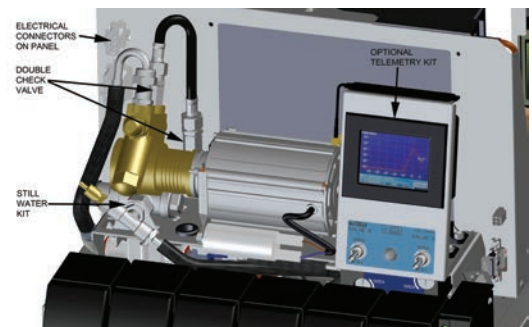

Smart Flexibility

A complete range of configurations ensures utmost flexibility. The new flexi flow system and the still water kit allows to immediately switch from dispensing a carbonated drink to a non carbonated drink whilst maintaining consistent water pressure, ensuring high quality beverages.

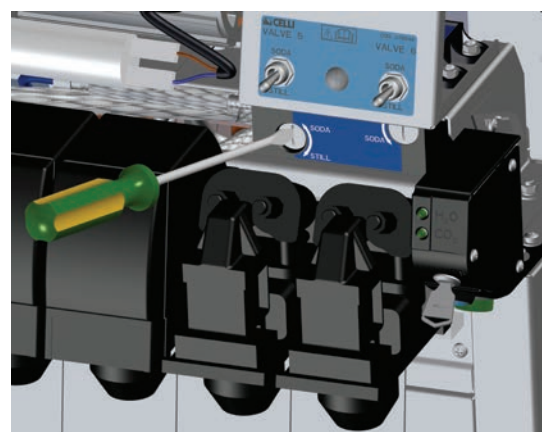



Excellent Protection

Control system optimization to prevent cooler malfunctioning ensure experience according to Celli's philosophy and beverage quality.

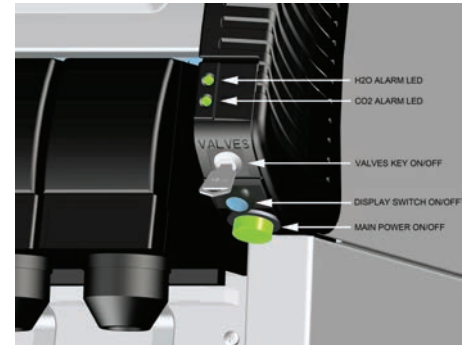
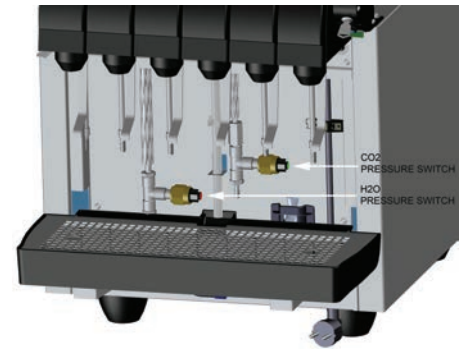

Powerful Branding

Celli is your best partner to strengthen your brand for a powerful communication action. The new Joy range was designed to enhance your brand with eye-catching customized areas and powerful lighting.



Strategic Intelligence

In order to support sales & marketing decision makers, Celli created a Telemetry System capable to provide important data assets. Telemetry also optimizes dispenser efficiency, alerting users to malfunction risks and preventing breakdowns.

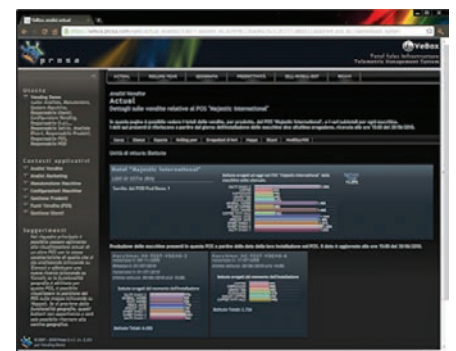

Joy range

Best-in-class green overcounter

A complete range of configurations to meet any need

	EASY	EASY LED	PROTECTION	FLEXI*	TELEMETRY*
SMART FLEXIBILITY flexi flow still water kit	X	X	X	✓	✓
EXCELLENT PROTECTION pressure switches	X	X	✓	✓	✓
STRATEGIC INTELLIGENCE telemetry	X	X	X	X	✓
POWERFUL BRANDING front LED illumination	X	✓	✓	✓	✓
Magnetic Branding	OPTIONAL	OPTIONAL	OPTIONAL	OPTIONAL	OPTIONAL

* joy 20 not included

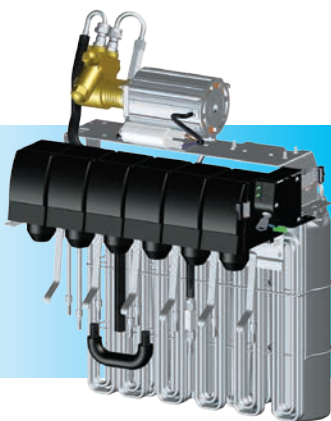

EASY

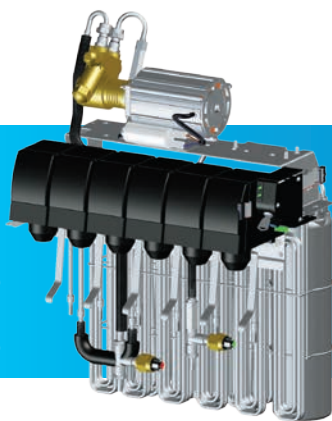

PROTECTION



FLEXI



TELEMETRY

Joy 20

Technical Sheet

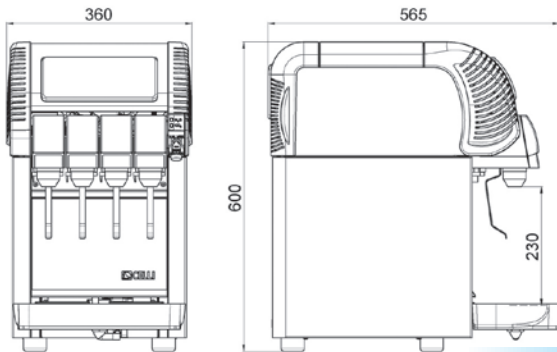

Pepsi Performance Specifications

VERY HIGH AMBIENT CONDITIONS	105°F (40,5°C)	75% HUM
HIGH AMBIENT CONDITIONS	90°F (32°C)	65% HUM
NORMAL CONDITIONS	75°F (24°C)	45% HUM



cod. 80368 Joy 50 Pepsi full telemetry

TANK CAPACITY: **17 L**
 ICE BANK: **6 KG = 13 LBS**
 COMPRESSOR: **1/5 HP**
 COOLING CAPACITY: **401 W**
 REFRIGERANT: **R290 (PROPANE) OR R134a**
 CARBONATION PUMP: **300 L/H**
 CARBONATOR TOTAL VOLUME: **700 CC**
 HOUSING MATERIAL: **STAINLESS STEEL**
 COIL MATERIAL: **STAINLESS STEEL AISI 304**
 (PICKLED AND PASSIVATED)

N° OF VALVES: **4**
 DIMENSIONS (L X W X H): **565 X 360 X 600 MM**
 **22.24 X 14.17 X 23.62 INCH**
 PRODUCT WEIGHT: **39 KG = 85 LBS**
 BOX DIMENSIONS: **710 X 510 X 650 MM**
 **27.95 X 20.07 X 25.59 INCH**
 ELECTRICAL RATING: **230V/50HZ**
 POWER INPUT: **410 W**

Joy 30

Technical Sheet

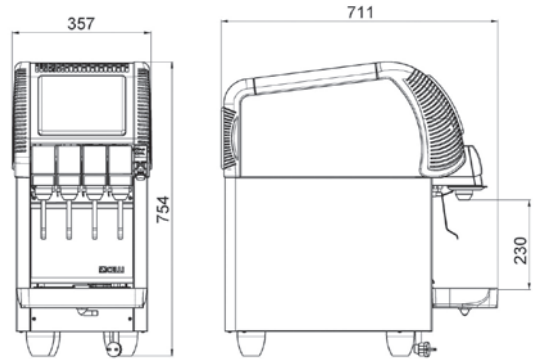

Pepsi Performance Specifications



cod. 79877 Joy 30 Pepsi full telemetry

VERY HIGH AMBIENT CONDITIONS	105°F (40,5°C) 75% HUM
HIGH AMBIENT CONDITIONS	90°F (32°C) 65% HUM
NORMAL CONDITIONS	75°F (24°C) 45% HUM

TANK CAPACITY: 28 L
 ICE BANK: 9 KG = 19,84 LBS
 COMPRESSOR: 1/3 HP
 COOLING CAPACITY: 625 W
 REFRIGERANT: R290 (PROPANE) OR R134a
 CARBONATION PUMP: 300 L/H
 CARBONATOR TOTAL VOLUME: 1800 CC
 HOUSING MATERIAL: STAINLESS STEEL
 COIL MATERIAL: STAINLESS STEEL AISI 304
 (PICKLED AND PASSIVATED)

N° OF VALVES: 4
 DIMENSIONS (L X W X H): 711 X 357 X 754 MM
 27.99 X 14.07 X 29.68 INCH
 PRODUCT WEIGHT: 50 KG = 110 LBS
 BOX DIMENSIONS: 800 X 450 X 785 MM
 31.49 X 17.71 X 30.90 INCH
 ELECTRICAL RATING: 230V/50HZ
 POWER INPUT: 830 W

Joy 50

Technical Sheet

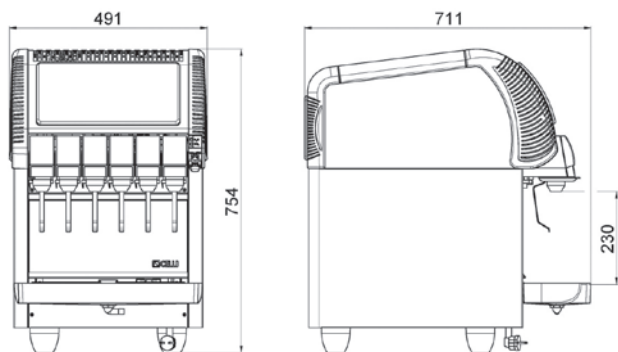

Pepsi Performance Specifications

VERY HIGH AMBIENT CONDITIONS	105°F (40,5°C) 75% HUM
HIGH AMBIENT CONDITIONS	90°F (32°C) 65% HUM
NORMAL CONDITIONS	75°F (24°C) 45% HUM



cod. 79520 Joy 50 Pepsi full telemetry

TANK CAPACITY: 45 L
 ICE BANK: 12 KG = 26 LBS
 COMPRESSOR: 1/2 HP
 COOLING CAPACITY: 905 W
 REFRIGERANT: R290 (PROPANE) OR R134a
 CARBONATION PUMP: 300 L/H
 CARBONATOR TOTAL VOLUME: 1800 CC
 HOUSING MATERIAL: STAINLESS STEEL
 COIL MATERIAL: STAINLESS STEEL AISI 304
 (PICKLED AND PASSIVATED)

N° OF VALVES: 6
 DIMENSIONS (L X W X H): 711 X 491 X 754 MM
 27.99 X 19.33 X 29.68 INCH
 PRODUCT WEIGHT: 66 KG = 145 LBS
 BOX DIMENSIONS: 800 X 590 X 785 MM
 31.49 X 23.22 X 30.90 INCH
 ELECTRICAL RATING: 230V/50HZ
 POWER INPUT: 910 W

Joy 65

Technical Sheet

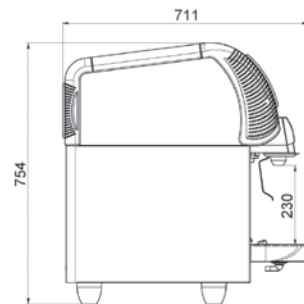
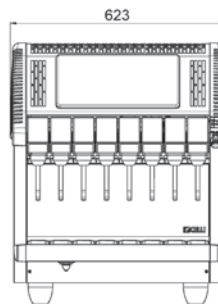

cod. 77966 Joy 65 Pepsi full telemetry

TANK CAPACITY: 59 L
ICE BANK: 19,8 KG = 43,76 LBS
COMPRESSOR: 3/4 HP
COOLING CAPACITY: 1287 W
REFRIGERANT: R290 (PROPANE) OR R134a
CARBONATION PUMP: 300 L/H
CARBONATOR TOTAL VOLUME: 1800 CC
HOUSING MATERIAL: STAINLESS STEEL

COIL MATERIAL: STAINLESS STEEL AISI 304
(PICKLED AND PASSIVATED)
N° OF VALVES: 8
DIMENSIONS (L X W X H): 711 X 623 X 754 MM
27.99 X 24.53 X 29.68 INCH
PRODUCT WEIGHT: 83 KG = 182 LBS
ELECTRICAL RATING: 230V/50HZ
POWER INPUT: 930 W

Smart

the ultimate solution for
low-volume premises



The most compact

The most affordable

*Great design for a superb
drinking experience!*

The R&D department of CELLI leveraged on its 40-year experience to develop a post-mix countertop equipment to address the needs of low-volume premises: compact footprint and affordable price.

With its limited bulk, it is the smallest of its category. Easy operation, minimal size, minimized TCO make SMART the best solution for low-volume premises to enjoy all the benefits of the fountain business.

Well-balanced lines and proportions characterize the smallest Celli equipment as a nice-looking and functional object, suited for premises with limited available space.

Eye-catching blue Pepsi housing and brand valorization with the backlit logo that stands out harmoniously against the front and sticker magnets.

Care for the environment is crucial also for such a small-sized equipment, which features a 30-mm HFC-free CO₂ polyurethane foam tank insulation to reduce heat dispersion and uses an eco-friendly R290 cooling gas (propane).

These characteristics make the new SMART the ultimate solution for a small-sized or low-volume venues.

Smart range

the ultimate solution for low-volume premises



Brand Empowerment

- Powerful brand communication with wide customized areas
- Highly attractive side branding magnets
- Thermoformed backlit front shield
- Eye-catching blue Pepsi housing



Design

- All-Italian design
- Modern look and feel
- Elegant lines and harmonious proportions



Performance & Consumptions

- Proven technology provides best-in-class reliability
- High-quality components
- Low energy consumption



Maintenance

- Easily accessible refrigerating unit
- No need to disconnect the hydraulic parts or syrup pipes
- Ease of use: reduced installation time and quick access to key components



Environment

GREAT CARE FOR THE ENVIRONMENT
WITHOUT COMPROMISES ON PERFORMANCE

- Environment-friendly thanks to the R290 cooling gas
- Energy-saving solutions
- 30-mm HFC-free tank insulation to reduce heat loss

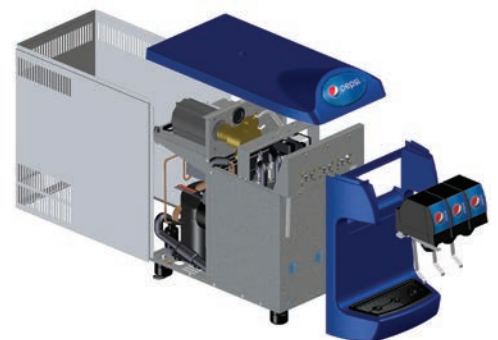
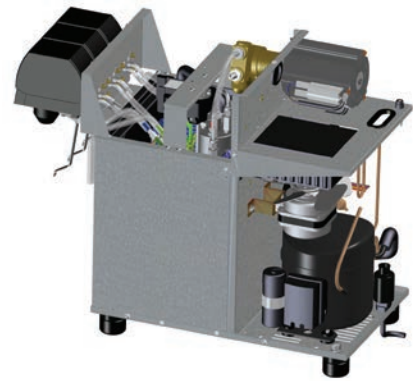

Smart

Technical Sheet

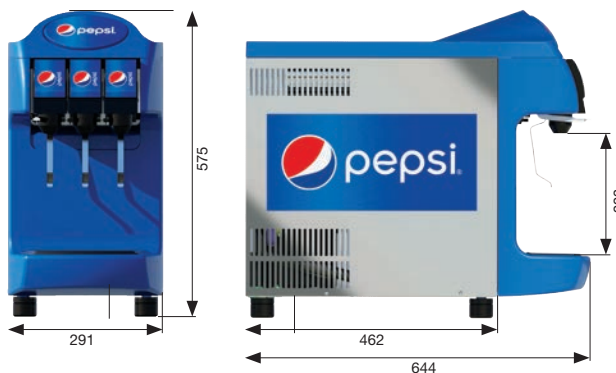

cod. 77997 Smart Pepsi 3 valves

TANK CAPACITY: 7 L
 ICE BANK: 4,5 KG = 9 LBS
 COMPRESSOR: 1/6 HP
 COOLING CAPACITY: 300 W
 REFRIGERANT: R290 (PROPANE) OR R134a
 CARBONATION PUMP: 200 L/H
 CARBONATOR TOTAL VOLUME:..... 700 CC
 BACKLIT LOGO..... YES

HOUSING MATERIAL: STAINLESS STEEL
 COIL MATERIAL: AISI 304
 N° OF VALVES: 3
 BOX DIMENSIONS (L X W X H): 760 X 455 X 625 MM
 29.92 X 17.91 X 24.60 INCH
 PRODUCT WEIGHT: 39 KG = 85 LBS
 ELECTRICAL RATING:230V/50HZ
 POWER INPUT: 250 W

Polo 30

Technical Sheet

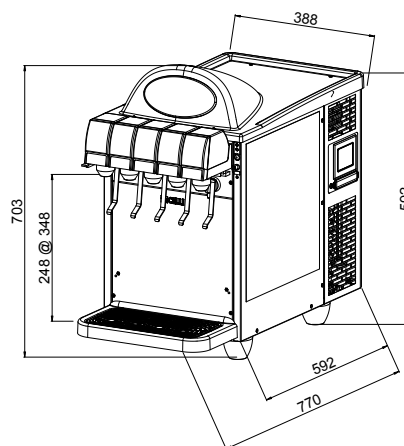

FRONT PANEL WITH ILLUMINATED BRANDING

AVAILABLE ALSO IN PRE-MIX VERSION

LARGE ICE BANK CAPACITY

MAXIMUM EFFICIENCY

BEST VALUE FOR MONEY

TANK CAPACITY: 25 L
 ICE BANK: 12 KG = 26 LBS
 COMPRESSOR: 1/3 HP
 COOLING CAPACITY: 625 W
 REFRIGERANT: R290 (PROPANE) OR R134a
 CARBONATION PUMP: 400 L/H
 CARBONATION PUMP MOTOR: 250 W
 CARBONATOR TOTAL VOLUME: 1800 CC
 BACKLIT LOGO: YES
 HOUSING MATERIAL: STAINLESS STEEL

COIL MATERIAL: STAINLESS STEEL AISI 304 (PICKLED AND PASSIVATED)
 MAX N° OF SYRUPS COILS..... 5
 DIMENSIONS (L X W X H): 667 X 454 X 696 MM
 26.25 X 17.87 X 27.40 INCH
 PRODUCT WEIGHT: 46 KG = 101 LBS
 BOX DIMENSIONS: 765 X 383 X 587 MM
 30.11 X 15.07 X 23.11 INCH
 ELECTRICAL RATING: 230V/50HZ
 POWER INPUT: 360 W

Polo 50

Technical Sheet

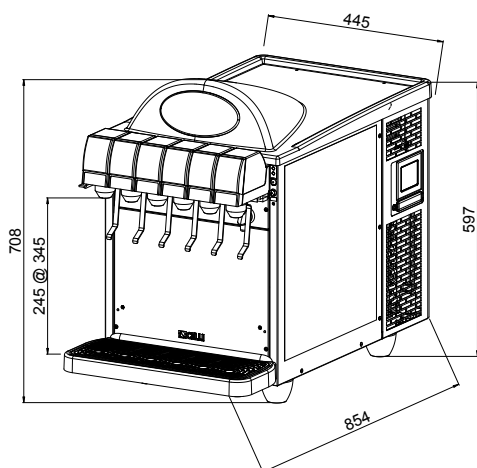

FRONT PANEL WITH ILLUMINATED BRANDING

**AVAILABLE ALSO IN
PRE-MIX VERSION**

**LARGE ICE
BANK CAPACITY**

**MAXIMUM
EFFICIENCY**

**BEST VALUE
FOR MONEY**

TANK CAPACITY: 45 L
 ICE BANK: 20 KG = 44 LBS
 COMPRESSOR: 1/2 HP
 COOLING CAPACITY: 849 W
 REFRIGERANT: R290 (PROPANE) OR R134a
 CARBONATION PUMP: 300 L/H
 CARBONATION PUMP MOTOR: 180 W
 CARBONATOR TOTAL VOLUME: 1800 CC
 BACKLIT LOGO: YES
 HOUSING MATERIAL: STAINLESS STEEL

COIL MATERIAL: STAINLESS STEEL AISI 304
 (PICKLED AND PASSIVATED)
 MAX N° OF SYRUPS COILS..... 6
 DIMENSIONS (L X W X H): 755 X 510 X 700 MM
 29.72 X 20.07 X 27.55 INCH
 PRODUCT WEIGHT: 60 KG = 132 LBS
 BOX DIMENSIONS: 856 X 440 X 600 MM
 33.70 X 17.32 X 23.62 INCH
 ELECTRICAL RATING: 230V/50HZ
 POWER INPUT: 680 W

Overcounter range



Joy 20 Joy 30 Joy 50 Joy 65 Smart Polo 30 Polo 50

TANK CAPACITY	L	17	28	45	59	7	25	45
ICE BANK	KG	6	9	12	19,8	4,5	12	20
	LBS	13	19,84	26	43,76	9	26	44
COMPRESSOR	HP	1/5	1/3	1/2	3/4	1/6	1/3	1/2
COOLING CAPACITY	W	401	625	905	1287	300	625	849
REFRIGERANT		R290 (PROPANE) OR R134a						
CARBONATION PUMP	L/H	300	300	300	300	200	400	300
CARBONATION PUMP MOTOR	L/H	-	-	-	-	-	250	180
CARBONATOR TOTAL VOLUME	CC	700	1800	1800	1800	700	1800	1800
BACKLIT LOGO		-	-	-	-	YES	YES	YES
HOUSING MATERIAL		STAINLESS STEEL						
COILS MATERIAL		STAINLESS STEEL AISI 304 (PICKLED AND PASSIVATED)						
N° OF VALVES		4	4	6	8	3	5	6
DIMENSIONS (L X W X H)	MM	565x360x600	711x357x754	711x491x754	711x623x754	-	667x454x696	755x510x700
	INCH	22.24x14.17x23.62	27.99x14.07x29.68	27.99x19.33x29.68	27.99x24.53x29.68	-	26.25x17.87x27.40	29.72x20.07x27.55
PRODUCT WEIGHT	KG	39	50	66	83	39	46	60
	LBS	85	110	145	182	85	101	132
BOX DIMENSIONS (L X W X H)	MM	710x510x650	800x450x785	800x590x785	-	760x455x625	765x383x587	856x440x600
	INCH	27.95x20.07x25.59	31.49x17.71x30.90	31.49x23.22x30.90	-	29.92x17.91x24.60	30.11x15.07x23.11	33.70x17.32x23.62
ELECTRICAL RATING	V/HZ	230/50	230/50	230/50	230/50	230/50	230/50	230/50
POWER INPUT	W	410	830	910	930	250	360	680

Brave

the ideal weapon
for your global accounts



Consistent reliability

High performance

Minimized TCO

The Brave range was designed to satisfy the highest standards of beverage groups.

Major catering groups seek reliability, easy installation, and low consumptions in their equipment to minimize the total cost of ownership without compromises in terms of performance.

The Brave range is equipped with long-life and low consumption components, design solutions that allow easy installation and maintenance, as well as the telemetry technology for strategic equipment operation.

This is why our Brave 120, 90 and 60 products were tested and selected by YUM! as the ideal equipment for its more than 2000 restaurants in Europe.

Tested & selected by



Brave range

the ideal weapon for your global accounts



Energy consumption & Environment

The Brave range is focused on environmental awareness. Energy-saving solutions based on eco-friendly cooling gases are the most successful way to surf the ecological wave.



Excellent Performance

Celli always guarantees high-quality materials. The Brave range meets the performance specifications of Pepsi at very demanding ambient conditions: 40,5 °C and 75% HUM. Brave 120, 90 and 60 were tested directly on several POS and was approved by YUM! for their global operations.



Maintenance & Protection

The Brave range was engineered for smart maintenance and easy servicing thanks to components standardization. Its control system (H₂O and CO₂ pressure alarms) was optimized to prevent cooler malfunctions and ensure the best drinking experience.



Strategic Intelligence

In order to support sales & marketing decision makers, Celli created a Telemetry System capable to provide important data assets. Telemetry also optimizes dispenser efficiency, alerting users to malfunction risks and preventing breakdowns.

Brave 120

Technical Sheet

DIAGNOSTIC DISPLAY

TELEMETRY

CONTROL BOX

ES SODA
RECIRCULATION MOTOR

ES AGITATOR

2 FLOWMETERS (ONE FOR EACH
WATER-INLET) FOR TELEMETRY



Pepsi Performance Specifications

VERY HIGH AMBIENT CONDITIONS	105°F (40,5°C)	75% HUM
HIGH AMBIENT CONDITIONS	90°F (32°C)	65% HUM
NORMAL CONDITIONS	75°F (24°C)	45% HUM

TANK CAPACITY: 110 L
 ICE BANK: 50 KG = 110 LBS
 COMPRESSOR: 2 X 1 HP
 COOLING CAPACITY: 2 X 2100 W
 REFRIGERANT: R290 (PROPANE) OR R134a
 CARBONATION PUMP: 2 X 400 L/H
 SODA RECIRCULATION PUMP: 2 X 300 L/H
 CARBONATOR TOTAL VOLUME: 6300 CC
 HOUSING MATERIAL: STAINLESS STEEL

COIL MATERIAL: STAINLESS STEEL AISI 304
 (PICKLED AND PASSIVATED)
 N° OF COILS: 12
 DIMENSIONS (L X W X H): 1170 X 681 X 871 MM
 46.06 X 26.81 X 34.29 INCH
 PRODUCT WEIGHT: 191 KG = 421 LBS
 BOX DIMENSIONS (L X W X H): 1210 X 765 X 968 MM
 47.63 X 30.11 X 38.11 INCH
 ELECTRICAL RATING: 230V/50HZ
 POWER INPUT: 2700 W



1000 kg of emitted
CO₂ less per year



cod. 78024 Brave 120 full telemetry

Brave 90

Technical Sheet



DIAGNOSTIC DISPLAY

TELEMETRY

CONTROL BOX

ES SODA
RECIRCULATION MOTOR

ES AGITATOR

2 FLOWMETERS (ONE FOR EACH
WATER-INLET) FOR TELEMETRY



 **CO₂** 600 kg of emitted
CO₂ less per year



Pepsi Performance Specifications

VERY HIGH AMBIENT CONDITIONS	105°F (40,5°C) 75% HUM
HIGH AMBIENT CONDITIONS	90°F (32°C) 65% HUM
NORMAL CONDITIONS	75°F (24°C) 45% HUM

cod. 78013 Brave 90 full telemetry

TANK CAPACITY: 77 L
 ICE BANK: 34 KG = 74 LBS
 COMPRESSOR: 1 HP
 COOLING CAPACITY: 2100 W
 REFRIGERANT: R290 (PROPANE) OR R134a
 CARBONATION PUMP: 400 L/H
 SODA RECIRCULATION PUMP: 300 L/H
 CARBONATOR TOTAL VOLUME: 2 X 3500 CC
 HOUSING MATERIAL: STAINLESS STEEL

COIL MATERIAL: STAINLESS STEEL AISI 304
 (PICKLED AND PASSIVATED)
 N° OF COILS: 10
 DIMENSIONS (L X W X H): 888 X 576 X 816 MM
 34.96 X 22.67 X 32.12 INCH
 PRODUCT WEIGHT: 124 KG = 273 LBS
 BOX DIMENSIONS (L X W X H): 930 X 665 X 920 MM
 36.61 X 26.18 X 36.22 INCH
 ELECTRICAL RATING: 230V/50HZ
 POWER INPUT: 950 W

Brave 60

Technical Sheet

DIAGNOSTIC DISPLAY

TELEMETRY

CONTROL BOX

ES SODA
RECIRCULATION MOTOR

ES AGITATOR



Pepsi Performance Specifications

VERY HIGH AMBIENT CONDITIONS	105°F (40,5°C) 75% HUM
HIGH AMBIENT CONDITIONS	90°F (32°C) 65% HUM
NORMAL CONDITIONS	75°F (24°C) 45% HUM

TANK CAPACITY: 56 L
 ICE BANK: 20 KG = 44 LBS
 COMPRESSOR: 5/8 HP
 COOLING CAPACITY: 1200 W
 REFRIGERANT: R290 (PROPANE) OR R134a
 CARBONATION PUMP: 400 L/H
 SODA RECIRCULATION PUMP: 300 L/H
 CARBONATOR TOTAL VOLUME:..... 2262 CC
 HOUSING MATERIAL: STAINLESS STEEL

COIL MATERIAL: STAINLESS STEEL AISI 304
 (PICKLED AND PASSIVATED)
 N° OF COILS: 8
 DIMENSIONS (L X W X H): 722 X 491 X 607 MM
 28.42 X 19.33 X 23.89 INCH
 PRODUCT WEIGHT: 86 KG = 189 LBS
 BOX DIMENSIONS (L X W X H): 795 X 565 X 670 MM
 31.29 X 22.24 X 26.37 INCH
 ELECTRICAL RATING:230V/50HZ
 POWER INPUT: 700 W



800 kg of emitted CO₂ less per year



cod. 78026 Brave 60 full telemetry

Brave 30

Technical Sheet



DIAGNOSTIC DISPLAY

TELEMETRY

CONTROL BOX

ES SODA
RECIRCULATION MOTOR

ES AGITATOR



 **CO₂** 600 kg of emitted
CO₂ less per year



Pepsi Performance Specifications

VERY HIGH AMBIENT CONDITIONS	105°F (40,5°C) 75% HUM
HIGH AMBIENT CONDITIONS	90°F (32°C) 65% HUM
NORMAL CONDITIONS	75°F (24°C) 45% HUM

TANK CAPACITY: 30 L
 ICE BANK: 10,1 KG = 22 LBS
 COMPRESSOR: 1/3 HP
 COOLING CAPACITY: 869 W
 REFRIGERANT: R290 (PROPANE) OR R134a
 CARBONATION PUMP: 400 L/H
 SODA RECIRCULATION PUMP: 300 L/H
 CARBONATOR TOTAL VOLUME: 1800 CC
 HOUSING MATERIAL: STAINLESS STEEL

COIL MATERIAL: STAINLESS STEEL AISI 304
 (PICKLED AND PASSIVATED)
 N° OF COILS: 6
 DIMENSIONS (L X W X H): 632 X 436 X 583 MM
 24.88 X 17.16 X 22.95 INCH
 PRODUCT WEIGHT: 70 KG = 154 LBS
 BOX DIMENSIONS (L X W X H): 710 X 510 X 650 MM
 27.95 X 20.07 X 25.59 INCH
 ELECTRICAL RATING: 230V/50HZ
 POWER INPUT: 850 W

Eclipse

All that you need in
an affordable machine



Highest quality standard

Easy access to key component

*Energy-saving solution and
excellent performance*

Eclipse horizontal

Technical Sheet



cod. 78029 Eclipse hor full telemetry

TANK CAPACITY:	31 L	COIL MATERIAL:.....	STAINLESS STEEL AISI 304 (PICKLED AND PASSIVATED)
ICE BANK:	13 KG = 28 LBS	N° OF COILS:	6
COMPRESSOR:	1/2 HP	DIMENSIONS (L X W X H):.....	866 X 453 X 476 MM 34.09 X 17.83 X 18.74 INCH
COOLING CAPACITY:	849 W	PRODUCT WEIGHT:	66 KG = 145 LBS
REFRIGERANT:	R290 (PROPANE) OR R134a	BOX DIMENSIONS (L X W X H):.....	910 X 470 X 500 MM 35.82 X 18.50 X 19.68 INCH
CARBONATION PUMP:	400 L/H	ELECTRICAL RATING:	230V/50HZ
CARBONATION PUMP MOTOR.....	245 W	POWER INPUT:570 W
SODA RECIRCULATION PUMP.....	300 L/H		
CARBONATOR TOTAL VOLUME:.....	2000 CC		
HOUSING MATERIAL:	STAINLESS STEEL		

Eclipse vertical

Technical Sheet



cod. 79863 Eclipse ver full telemetry

TANK CAPACITY: **31 L**
 ICE BANK: **15 KG = 33 LBS**
 COMPRESSOR: **1/2 HP**
 COOLING CAPACITY: **849 W**
 REFRIGERANT: **R290 (PROPANE) OR R134a**
 CARBONATION PUMP: **400 L/H**
 CARBONATION PUMP MOTOR..... **245 W**
 SODA RECIRCULATION PUMP..... **300 L/H**
 CARBONATOR TOTAL VOLUME:..... **2000 CC**
 HOUSING MATERIAL: **STAINLESS STEEL**

COIL MATERIAL:.....**STAINLESS STEEL AISI 304
 (PICKLED AND PASSIVATED)**
 N° OF COILS: **6**
 DIMENSIONS (L X W X H):..... **605 X 489 X 763 MM
 23.81 X 19.25 X 30.03 INCH**
 PRODUCT WEIGHT: **65 KG = 143 LBS**
 BOX DIMENSIONS (L X W X H): **650 X 475 X 770 MM
 25.59 X 18.70 X 30.31 INCH**
 ELECTRICAL RATING: **230V/50HZ**
 POWER INPUT: **570 W**

Eclipse 50

Technical Sheet



OPTIONAL:

- BUILT-IN PRESSURE REDUCER*
- BUILT-IN WATER FILTER*
- MAGNETIC DRIVEN SODA RECIRCULATION PUMP

* ONLY FOR 6 BUILT-IN PUMPS VERSION



UP TO 8 BUILT-IN PNEUMATIC PUMPS

6/8 SYRUPS

TANK CAPACITY: 38 L
 ICE BANK: 17 KG = 37 LBS
 COMPRESSOR: 1/2 HP
 COOLING CAPACITY:1169 W
 REFRIGERANT: R290 (PROPANE) OR R134a
 CARBONATION PUMP: 400 L/H
 CARBONATION PUMP MOTOR..... 250 W
 SODA RECIRCULATION PUMP..... 300 L/H
 CARBONATOR TOTAL VOLUME:..... 2000 CC
 HOUSING MATERIAL: STAINLESS STEEL

COIL MATERIAL:.....STAINLESS STEEL AISI 304
 (PICKLED AND PASSIVATED)
 N° OF COILS: 6
 DIMENSIONS (L X W X H):..... 440 X 590 X 824 MM
 17.32 X 23.22 X 32.44 INCH
 PRODUCT WEIGHT: 70 KG = 154 LBS
 BOX DIMENSIONS (L X W X H):.....515 X 780 X 855 MM
 20.27 X 30.70 X 33.66 INCH
 ELECTRICAL RATING: 230V/50HZ
 POWER INPUT:1100 W

Cube

compact cooler
for flexible application



Small overall dimensions

*Excellent quality drinks in an entry
level machine*

Energy-saving solution

Cube

Technical Sheet

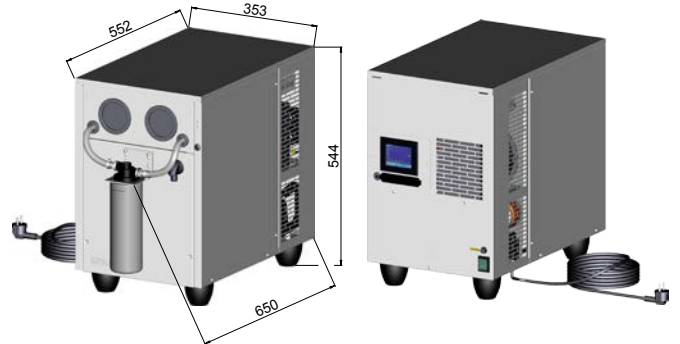

VERY COMPACT UNDER-COUNTER COOLER WITH SODA CIRCUIT



cod. 78293 Cube Pepsi 4 soda, still water, soda recirculation

TANK CAPACITY: 18 L
ICE BANK: 8 KG = 17 LBS
COMPRESSOR: 1/4 HP
COOLING CAPACITY: 453 W
REFRIGERANT: R290 (PROPANE) OR R134a
CARBONATION PUMP: 300 L/H
CARBONATION PUMP MOTOR..... 180 W
SODA RECIRCULATION PUMP..... 220 L/H
CARBONATOR TOTAL VOLUME:..... 1625 CC
HOUSING MATERIAL: STAINLESS STEEL

COIL MATERIAL:.....STAINLESS STEEL AISI 304
(PICKLED AND PASSIVATED)
N° OF COILS: 4
DIMENSIONS (L X W X H):..... 552 X 353 X 544 MM
21.73 X 13.89 X 21.41 INCH
PRODUCT WEIGHT: 49 KG = 108 LBS
BOX DIMENSIONS (L X W X H):.....625 X 425 X 605 MM
24.60 X 16.73 X 23.81 INCH
ELECTRICAL RATING: 230V/50HZ
POWER INPUT: 390 W

Undercounter range



		Brave 120	Brave 90	Brave 60	Brave 30	Eclipse hor	Eclipse vert	Eclipse 50	Cube
TANK CAPACITY	L	110	77	56	30	31	31	38	18
ICE BANK	KG	50	34	20	10,1	13	15	17	8
	LBS	110	74	44	22	28	33	37	17
COMPRESSOR	HP	2 X 1	1	5/8	1/3	1/2	1/2	1/2	1/4
COOLING CAPACITY	W	2 X 2100	2100	1200	869	849	849	1169	453
REFRIGERANT		R290 (PROPANE) OR R134a							
CARBONATION PUMP	L/H	2 X 400	400	400	400	400	400	400	300
CARBONATION PUMP MOTOR	L/H	-	-	-	-	245	245	250	180
SODA RECIRCULATION PUMP	L/H	2 X 300	300	300	300	300	300	300	220
CARBONATOR TOTAL VOLUME	CC	6300	2 X 3500	2262	1800	2000	2000	2000	1625
HOUSING MATERIAL		STAINLESS STEEL							
COILS MATERIAL		STAINLESS STEEL AISI 304 (PICKLED AND PASSIVATED)							
N° OF COILS		12	10	8	6	6	6	6	4
DIMENSIONS (L X W X H)	MM	1170x681x871	888x576x816	722x491x607	632x436x583	866x453x476	605x489x763	440x590x824	552x353x544
	INCH	46.06x26.81x34.29	34.96x22.67x32.12	28.42x19.33x23.89	24.88x17.16x22.95	34.09x17.83x18.74	23.81x19.25x30.03	17.32x23.22x32.44	21.73x13.89x21.41
PRODUCT WEIGHT	KG	191	124	86	70	66	65	70	49
	LBS	421	273	189	154	145	143	154	108
BOX DIMENSIONS (L X W X H)	MM	1210x765x968	930x665x920	795x565x670	710x510x650	910x470x500	650x475x770	515x780x855	625x425x605
	INCH	47.63x30.11x38.11	36.61x26.18x36.22	31.29x22.24x26.37	27.95x20.07x25.59	35.82x18.50x19.68	25.59x18.70x30.31	20.27x30.70x33.66	24.60x16.73x23.81
ELECTRICAL RATING	V/HZ	230/50	230/50	230/50	230/50	230/50	230/50	230/50	230/50
POWER INPUT	W	2700	950	700	850	570	570	1100	390

Drop-in



DROP-IN + FREESTANDING + COOL

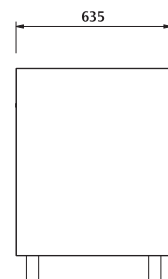
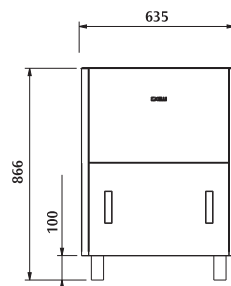
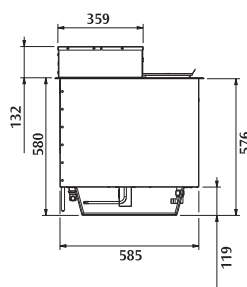
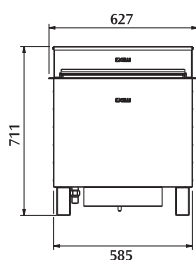

DROP-IN + COOL

Drop-in

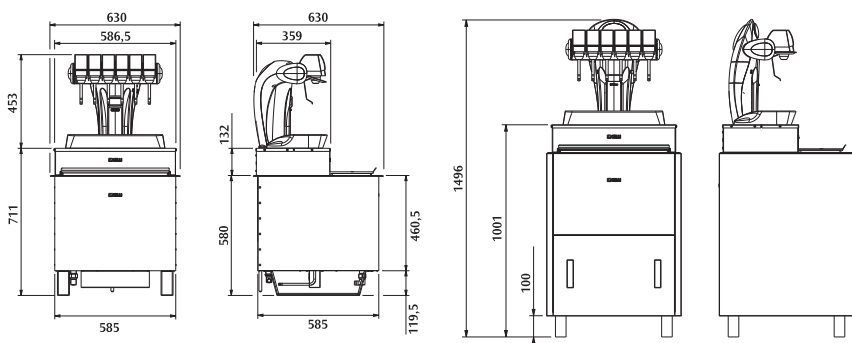

DROP-IN + TRISTAR



DROP-IN + FREESTANDING + COOL



DROP-IN + TRISTAR

- ICE BANK: 35 KG = 77 LBS
- CARBONATOR TOTAL VOLUME:..... 2450 CC
- OPTIONAL: **EXTERNAL BOX WITH TRANSFORMER AND PUMPS**
- HOUSING MATERIAL: **STAINLESS STEEL**
- COIL MATERIAL: **STAINLESS STEEL AISI 304 (PICKLED AND PASSIVATED)**
- MAX N° OF SYRUPS COILS: 8

Drop-in pump box

INTEGRATED TOWERS

ALSO AVAILABLE WITH 4,6,8 VALVES WITH OR WITHOUT FRONT PANEL WITH LIGHT

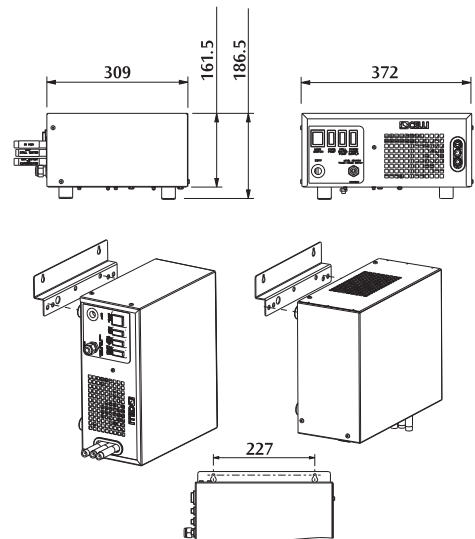
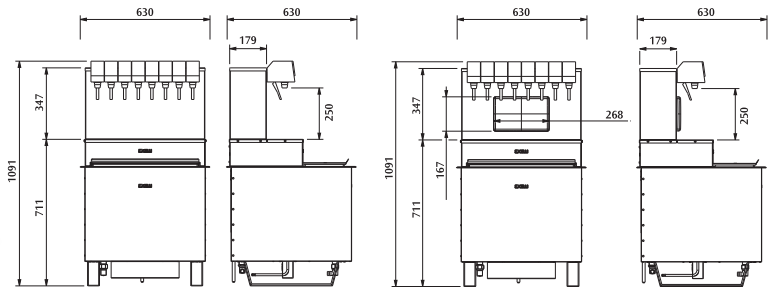

ALSO AVAILABLE WALL MOUNTING OPTION

AVAILABLE WITH STILL WATER AND CARBONATED + STILL WATER

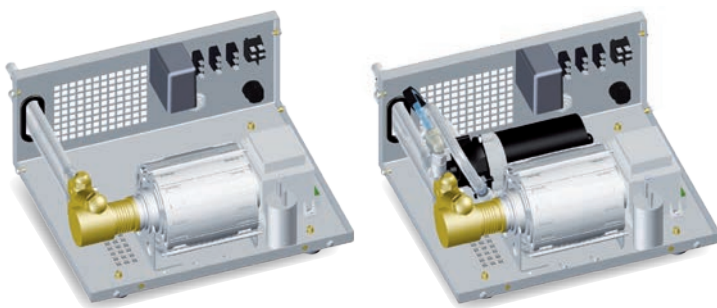

CARBONATION PUMP BOX

CARBONATION PUMP BOX + STILL WATER PUMP BOX

- CARBONATION PUMP: 400 L/H PROCON
- STILL WATER PUMP: 350 L/H
- TRANSFORMER: 160 VA
- HOUSING MATERIAL: SKIN PLATE OR STAINLESS STEEL

Wunder-Bar Gun



051523
POST-MIX BAR-GUN WUNDER-BAR WBM-851 5 CARBONATED DRINKS
+ 1 NON CARBONATED + SODA + STILL WATER

046588
PEPSI-COLA POST-MIX WUNDER-BAR GUN 4 CARBONATED DRINKS
+ 2 NON CARBONATED + SODA + STILL WATER



006961
PRE-MIX BAR-GUN WUNDER-BAR 5 DRINKS

Bar-Gun Holders



034887
BAR-GUN HOLDER MOD. BLUES

(*) BLACK PLASTIC GUN HOLDER NOT INCLUDED

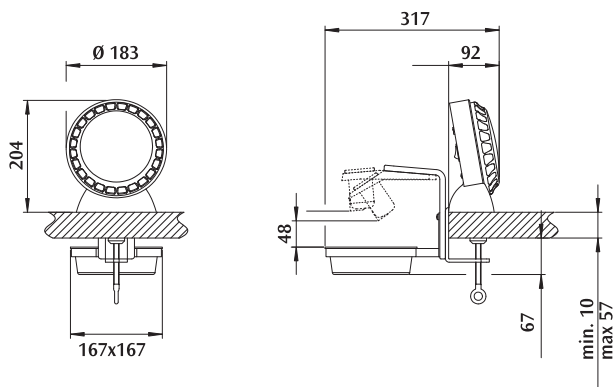

062470
ST. STEEL BAR-GUN HOLDER MOD. MIRA

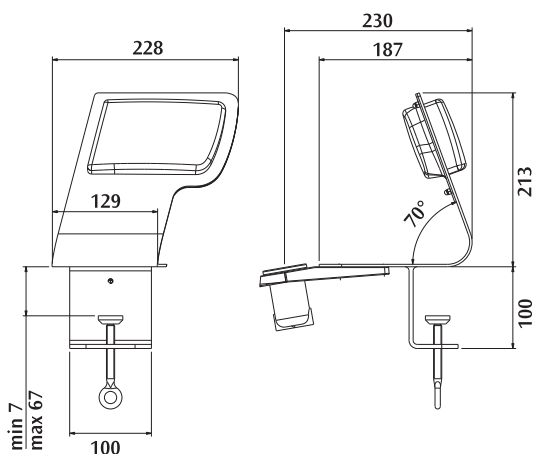

MOULDED BAR-GUN HOLDER MOD. SPLASH

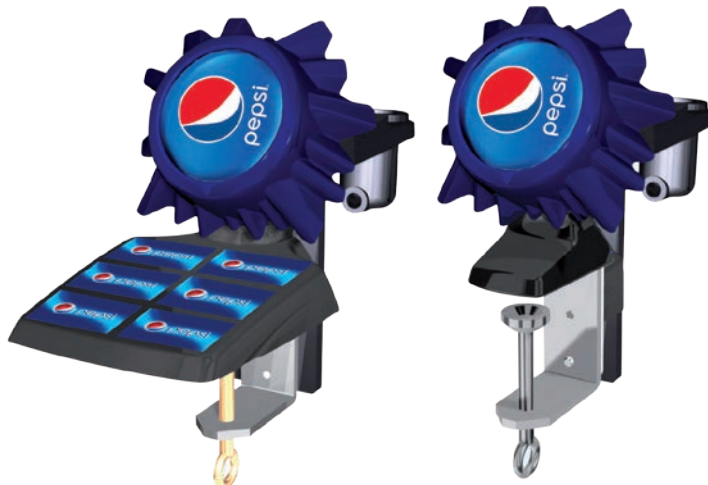
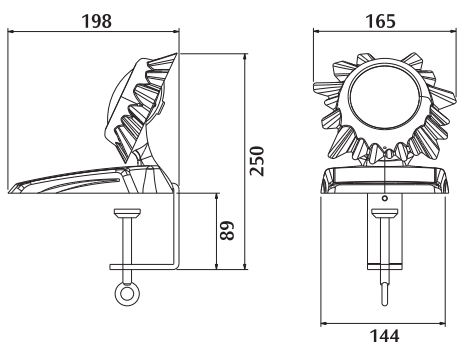

Accessories

SYRUP PUMPS

- A** 065276
N5000 PNEUMATIC
FLOJET PUMP
- B** 008120
PNEUMATIC
SHURFLO PUMP
LIQUID-OUT NIPPLE
IN STAINLESS STEEL
6 MM

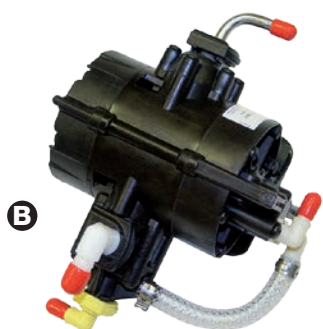
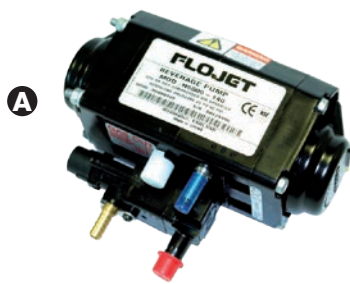

PUMPS

- A** 001061
BRASS PROCON PUMP
300 L WITH MECHANICAL
FILTER
- B** 005318
STAINLESS STEEL
PROCON PUMP 300 L
WITHOUT MECHANICAL
FILTER
- C** 025324
ELECTRICAL WATER
SHURFLO PUMP,
BY-PASS, PRESSURE
SWITCH, J.G. FITTING 9,5
230V-50HZ



FILTERS

- A** 062558
ALUMINIUM HEAD FOR
EVERPURE FILTER F 3/8"
- B** 002967
ACTIVE CARBON 4C
FOR EVERPURE WATER
FILTER QC4-C
- C** 003144
ACTIVE CARBON
CARTRIDGE MC2 FOR
EVERPURE WATER
FILTER MC2
- D** 051593
EVERPURE FILTER + UV
LAMP 11300 / 7500 HOURS



FITTINGS



Accessories

WATER SWITCH

WATER SWITCH IS A SYSTEM WHICH GIVES THE POSSIBILITY OF SWITCHING FROM SODA TO STILL WATER AND VICE VERSA ON UP TO THREE VALVES. THE CONFIGURATION SWITCH CAN BE EASILY OBTAINED BY CHANGING THE OUTFLOW TUBES AND STAINLESS STEEL CAPS POSITIONS

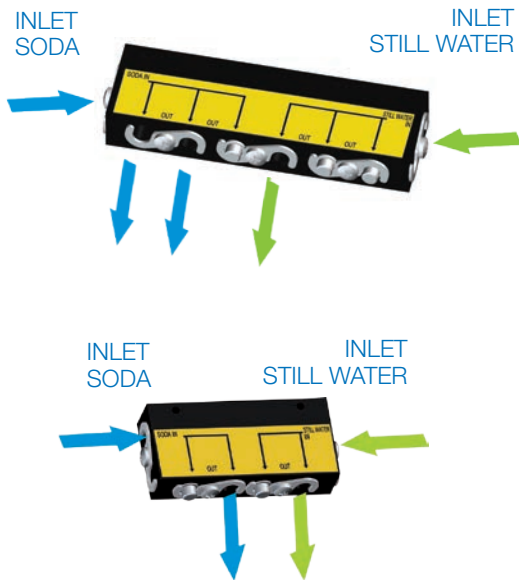

CHANGE THE CONFIGURATION OF THE STAINLESS STEEL CAPS TO GET THE REQUIRED OUTPUT

CORNELIUS VALVES

- A** 046607
UF1 CORNELIUS
VALVE ELECTRICAL WITH
FLOW-CONTROL
- B** 046585
UF1 CORNELIUS
VALVE ELECTRICAL WITH
PORTION CONTROL S-M-L
- C** 048281
MOUNTING BLOCK FOR
UF1 CORNELIUS VALVE

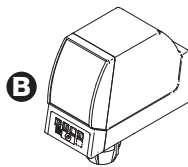
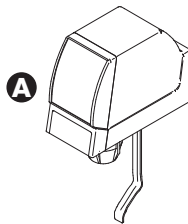

FLOMATIC VALVES

- A** 034994
FLOMATIC VALVE
ELECTRICAL WITH
PORTION CONTROL S-M-L
- B** 026030
FLOMATIC VALVE
ELECTRICAL WITH
FLOW-CONTROL
- 026029
B FLOMATIC VALVE
MECHANICAL WITH
FLOW-CONTROL
- 026013
C MOUNTING BLOCK 380-Q
FOR FLOMATIC VALVE
324/424

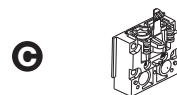
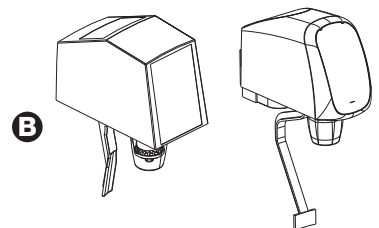
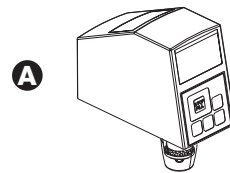

Our Certifications



REG. N. 045
UNI EN ISO 9001: 2000 • UNI EN ISO 14001: 2004
UNI EN ISO 14021: 2012 • UNI EN ISO 22000: 2005



CELLI S.p.A.
Via Casino Albini 605 - 47842 S. Giovanni in Marignano - Rimini - Italy
Tel +39 0541 755211 - Fax +39 0541 759735

www.celli.com